



24 Pembridge Square | Bayswater Paddington | London | W2 4DR

£1,855 Per Month



24 Pembridge Square | Bayswater
Paddington
London | W2 4DR

Situated in the heart of Notting Hill within the highly desirable W2 postcode, this well-presented first-floor studio apartment offers bright and comfortable living in one of West London's most sought-after neighbourhoods.

- First-floor studio apartment
- Prime Notting Hill location, W2
- Bright and spacious open-plan layout
- High ceilings and excellent natural light
- Separate fitted kitchenette
- Modern bathroom



Pembridge Square, W2 4DR

Approx Gross Internal Area = 30.46 sq m / 328 sq ft

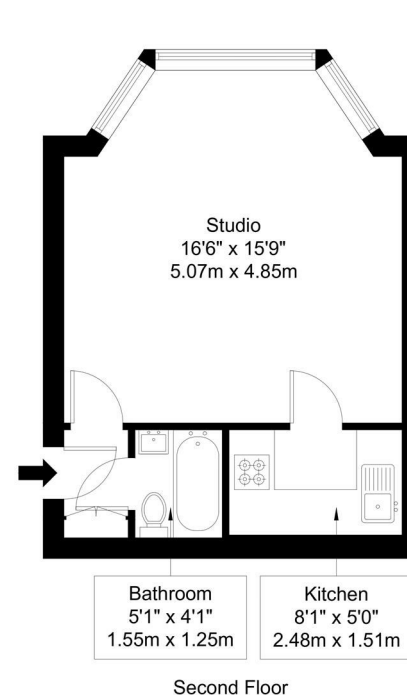

Energy Efficiency Rating		Current	Potential
<i>Very energy efficient - lower running costs</i>			
(92 plus) A			
(81-91) B			81
(69-80) C			
(55-68) D		62	
(39-54) E			
(21-38) F			
(1-20) G			
<i>Not energy efficient - higher running costs</i>			
England & Wales		EU Directive 2002/91/EC	

Council Tax Band B
EPC Rating D

10 Cromwell Place
London
SW7 2JN

02038 650611
lettings@cityrelay.com

Ref :

Copyright **BLEU PLAN**

The Floor plan is not to scale and measurements and areas shown are approximate and therefore should be used for illustrative purposes only. The plan has been prepared in accordance with the RICS code of Measuring Practice and whilst we have confidence in the information produced it must not be relied on. Maximum lengths and widths are represented on the floor plan. If there is any aspect of particular importance, you should carry out or commission your own inspection of the property.
Copyright @ BLEUPLAN